

Data sheet

SP02502HDNC ASP0250204-001

Page 1/6

P/N
ASP0250204-001

2025/08/25

Version: D

Illustrations



Dimensional drawing as an example

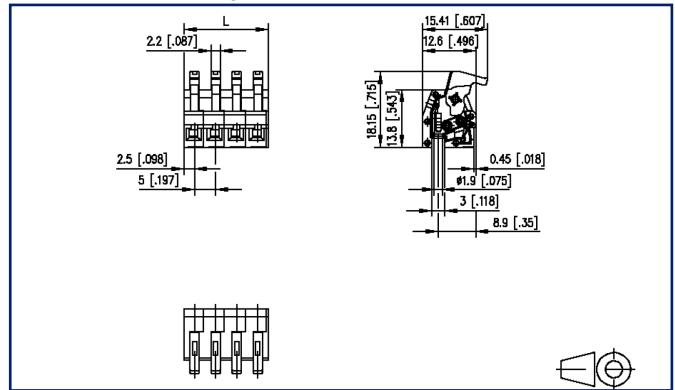

See enlarged drawings at the end of document

Product specification

- ethernet-capable spring clamp terminal block with eccentric lever, pluggable
- centerline 5.00 mm, direction of connection 90°
- fittable without loss of poles
- color gray, color coding for conductor colors according to SPE (white/blue)



Technical Data



General Data

pole size	2		
Insulating material class	CTI 600		
clearance/creepage dist.	3.7 mm		
Protection category	IP20		
Insul. strip length	4 mm		
Rated current	10 A		
Overvoltage category	III	III	II
Pollution degree	3	2	2
Rated voltage	40 V	250 V	250 V
Rated test voltage	2.5 kV	2.5 kV	2.5 kV

Terminal data

rat.wiring solid AWGmax	0.08 mm ² - 1.5 mm ² / AWG 28 - AWG 16
rat.wiring strand.AWGmax	0.08 mm ² - 0.75 mm ² / AWG 28 - AWG 18

Approvals

 V / A / AWG	300 / 8 / 28 - 16
approval UL - File No.	E121004
	250 V / 4 kV / 10 A

Transmission characteristics

Data transmission according to IEEE 802.3cg	10 Mbit/s up to 1.000 m STP
Data transmission according to IEEE 802.3bp	1Gbit/s up to 15 m UTP 1Gbit/s up to 40 m STP
Power transmission	PoDL, IEEE 802.3bu 60 W

Material

insulating material	PPA
flammability class	V0
spring material	Spring steel
contact material	CuSn
Contact surface	Sn
Glow-Wire Flammability GWFI	850 °C acc. to IEC 60695-2-12

Technical Data

Glow-Wire Flammability GWIT	775 °C acc. to IEC 60695-2-13
-----------------------------	-------------------------------

Climatic Data

upper limit temperature	105 °C
-------------------------	--------

lower limit temperature	-40 °C
-------------------------	--------

general

Tolerance	ISO 2768 -mH
-----------	--------------

Application note

This product is a standard product of METZ CONNECT. METZ CONNECT is not aware of the specific intended use of the goods by the Customer or any customers of the Customer. The Customer guarantees that it has fully and sufficiently tested the use of the goods and any product modifications, product changes or product enhancements with regard to the specific intended use in accordance with the state of the art or in any other way. At METZ CONNECT's request, the Customer shall submit and make available meaningful evidence (e.g. test and laboratory protocols, certifications, etc.).

Data sheet

Page 4/6

SP02502HDNC ASP0250204-001P/N
ASP0250204-0012025/08/25
Version: D**Accessories**

P/N	Designation
720036-01-4	Mounting flange gray for type ASP025
720036-02-2	Mounting flange black for type ASP025



Data sheet

Page 5/6

SP02502HDNC ASP0250204-001P/N
ASP0250204-0012025/08/25
Version: D**Counterpart**

P/N	Designation
310171	PR015xxVBHC Type 017
310411	PT065xxVBEN Type 041
314171	PM035xxVBHC Type 417



Illustrations

Dimensional drawing as an example

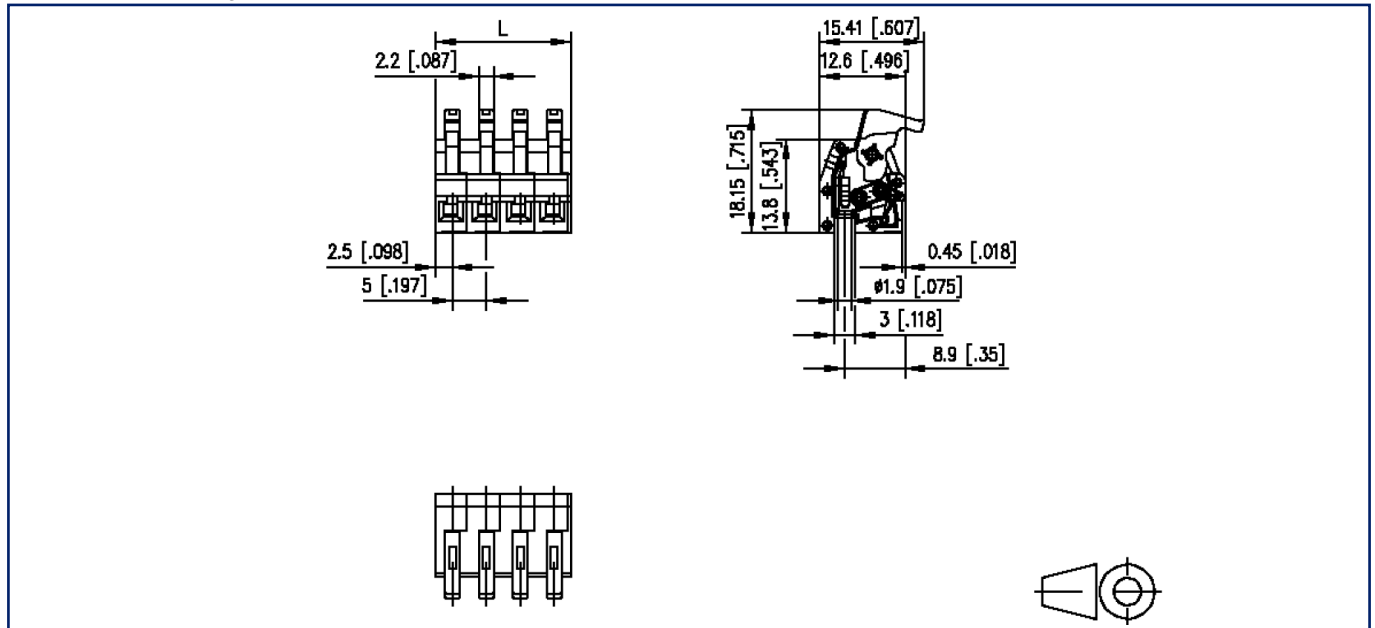

$$L = (\text{pole size} - 1) \times \text{centerline} + 5 \text{ mm } [0.197]$$